

# DUROCK<sup>®</sup> Cement Board

## Cement board wall shields and floor protectors for UL-listed solid-fuel room heaters and stoves

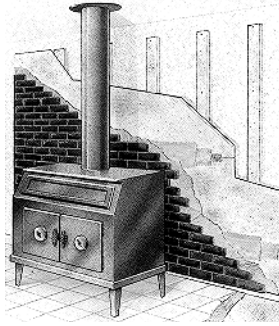

- Protects combustible walls and floors.
- Asbestos-free, yet highly fire-resistant.
- Reduces required wall clearances by two-thirds.
- Available in 6 convenient sizes for minimal cutting—3' x 4', 5' and 6'; 4' x 8'; and 32" x 5 and 8'.
- Attaches quickly and easily to wall furring for economical installation.

### Description

Space-saving DUROCK<sup>®</sup> Cement Boards are listed by Underwriters Laboratories, Inc., for use with UL-listed solid-fuel room heaters and fireplace stoves. Used as a wall shield, DUROCK Cement Board reduces by two-thirds the manufacturer-specified clearance (minimum 12") between the room heater or stove and a combustible wall surface. DUROCK Cement Board may also be used as a floor protector in place of one layer of 3/8" thick millboard.\*

DUROCK Cement Board is available in sizes 1/2" x 3' x 4', 5' and 6'; 1/2" x 4' x 8'; and 1/2" x 32" x 5' and 8'. Optional 5/8" thickness is also available. DUROCK Exterior Cement Board is available 1/2" thick x 4' x 8'. At only 3 lb./ft.<sup>2</sup>, (for 1/2" board) DUROCK Cement Boards install quickly and easily with nails or screws.

\*Having a thermal conductivity of  $k \leq 0.84$  Btu in./ft.<sup>2</sup> h °F in the minimum dimensions specified by the room heater/stove manufacturer.

### Wall Shield Reduced Clearances

The reduced clearances (minimum 12") with a wall shield of DUROCK Cement Board are shown below. Check the graph for the exact reduction you can make in the manufacturer's specified clearances and calculate the floor space you can reclaim.

### Minimum Wall Shield/ Floor Protector Extensions

The three technical drawings below show the minimum wall shield or floor protector extension beyond the room heater or stove.

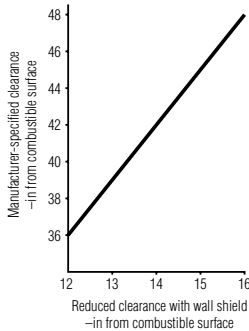

Stove to Wall Clearance

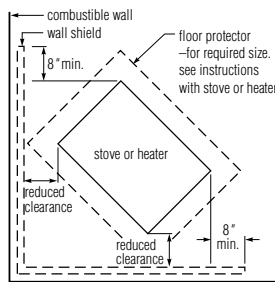

Plan View: Corner Installation

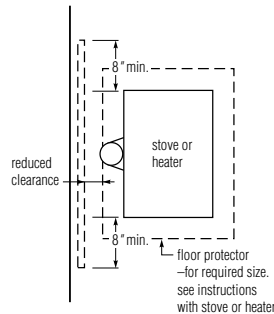

Plan View: Along-the-Wall Installation

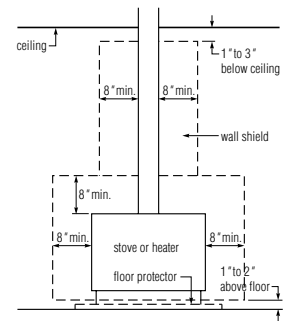

Front View: Corner or Wall Installation

### Directions

### Tools and materials

- Furring strips
- Scoring tool or circular saw
- Wood rasp
- 1-5/8" or 2-1/4" DUROCK Wood Screws
- 1-1/2", 2-1/4" or 2-3/4" galvanized roofing nails
- DUROCK<sup>™</sup> Interior Tape
- Mortar meeting ANSI Specification 118.4 or 118.1

### To install wall shield

- 1 Cut panel and furring strips to size with carbide-tip or utility knife scoring tool or circular saw using carbide tip blade. Smooth rough edges with wood rasp.
- 2 Attach DUROCK Cement Board furring strips to wall framing with 2-1/4" DUROCK Wood Screws or 2-1/4" galvanized roofing nails with 3/4" minimum framing penetration.
- 3 Attach DUROCK Cement Board wall shield through furring to wall framing with 2-3/4" galvanized roofing nails with 3/4" minimum framing penetration.

4 Prefill joints with latex-fortified portland cement mortar and then immediately embed tape and level the joints. As an alternative, apply DUROCK Tape over the joints and then apply latex-fortified portland cement mortar, forcing it through the tape to completely fill and level the joints. This may require several passes to accomplish.

**To install floor protector**

- 1 Apply 1/8" to 1/4" thick latex-fortified portland cement mortar to flat, continuous surfaces—never on top of carpeting or padding.
- 2 Attach DUROCK Cement Board with 1-5/8" DUROCK Wood Screws or 1-1/2" galvanized roofing nails at 8" o.c. both directions and with 3/4" minimum flooring penetration.
- 3 Prefill joints with latex-fortified portland cement mortar and then immediately embed tape and level the joints. As an alternative, apply DUROCK Tape over the joints and then apply latex-fortified portland cement mortar, forcing it through the tape to completely fill and level the joints. This may require several passes to accomplish.

**Finishing**

As an option, both wall shields and floor protectors may be finished with thin brick or ceramic or quarry tile set in a bed of mortar meeting ANSI 118.4 or 118.1.

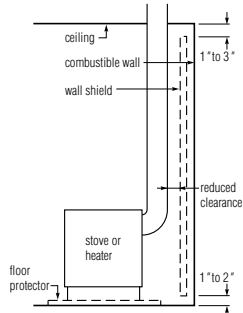

**Side View: Rear-Flue Stove**

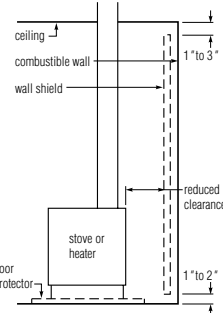

**Side View: Top-Flue Stove**

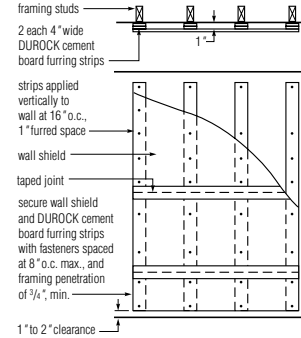

**Furred Wall Shield Attachment**

**Additional information**

For complete specifications and more information on DUROCK Cement Board products and systems, refer to:  
*SA932 DUROCK® Cement Board Systems*  
*SA700 Exterior Systems*

**Technical Services**

For specific technical assistance, call a USG Technical Representative at (800) USG-4YOU (874-4968).

**Product Data**

- Sizes and Packaging:** DUROCK Cement Board: 1/2" thickness (5/8" thickness optional), 36" width x lengths of 4', 5' and 6'; 4' width x 8' length; and 32" width x 5' and 8' length. Exterior Cement Board: 1/2" thickness, 48" width x 8' length.
- Standards:** DUROCK Cement Board is listed by Underwriters Laboratories, Inc., for use with UL-listed solid-fuel room heaters and fireplace stoves.
- Availability and Cost:** DUROCK Cement Board is distributed throughout the United States. Contact a United States Gypsum Company sales office or sales person for additional information.
- Composition and Materials:** DUROCK Cement Board is formed in a continuous process of aggregated portland cement slurry with polymer-coated, glass-fiber mesh completely encompassing edges, back and front surfaces. The edges are formed smooth—patent No. 4,916,004. The ends are square cut.
- Warranty:** Products and systems provided by United States Gypsum Company are warranted to be free from defects in material and workmanship. Contact a United States Gypsum Company sales office for complete warranty details.
- Maintenance:** Contact a United States Gypsum Company sales office for complete details.

**Submittal Approvals:**

<b>Job Name</b>	
<b>Contractor</b>	<b>Date</b>

**LISTED 34L2**  
 For floor protectors and wall shields

**Trademarks:**  
 The following trademarks used herein are owned by United States Gypsum Company: DUROCK.

**Note:**  
 Products described here may not be available in all geographic markets. Consult your U.S. Gypsum Company sales office or representative for information.

**Notice:**  
 We shall not be liable for incidental and consequential damages, directly or indirectly sustained, nor for any loss caused by application of these goods not in accordance with current printed instructions or for other than the intended use. Our liability is expressly limited to replacement of defective goods. Any claim shall be deemed waived unless made in writing to us within thirty (30) days from date it was or reasonably should have been discovered.

**SAFETY FIRST!**  
 Follow good safety and industrial hygiene practices during handling and installing all products and systems. Take necessary precautions and wear the appropriate personal protective equipment as needed. Read material safety data sheets and related literature on products before specification and/or installation.